

## Blind Corner Caddy

### Important Notes

- Always read the instructions completely and carefully before beginning assembly.
- Remove and check contents for damage and/or missing parts. Keep the original cartons and packing materials, which are required for any authorized adjustment by our dealers.
- These instructions are for reference only. Make sure installation procedures comply with all applicable building codes in your area.

### Assembly Instructions

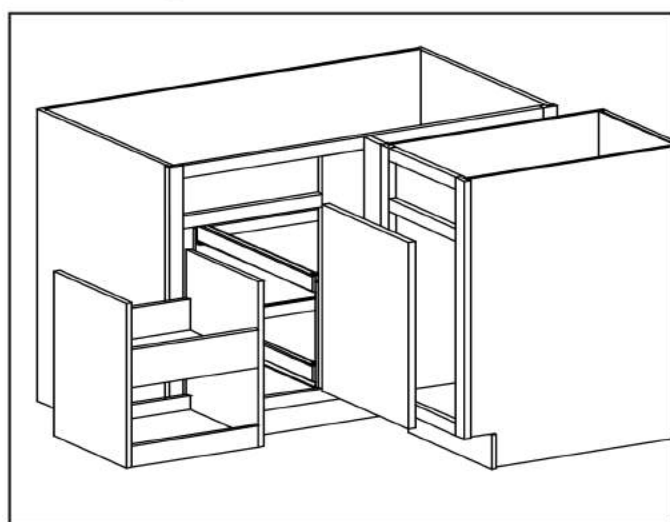

**Notes:** Cabinet door opening must be a minimum of 15 inches wide to install this unit.

To allow corner caddy to work properly cabinet door must be attached to opposite side of door opening from corner caddy

Remove Cabinet door for ease of installation.

**Step 1:** Turn drawer unit vertical with drawer fronts up and slide unit into cabinet (See figure 1)

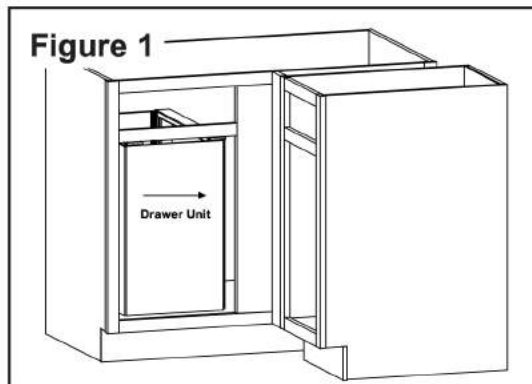

**Step 2:** Slide unit back into cabinet and then rotate front of unit downward into position. (See figure 2)

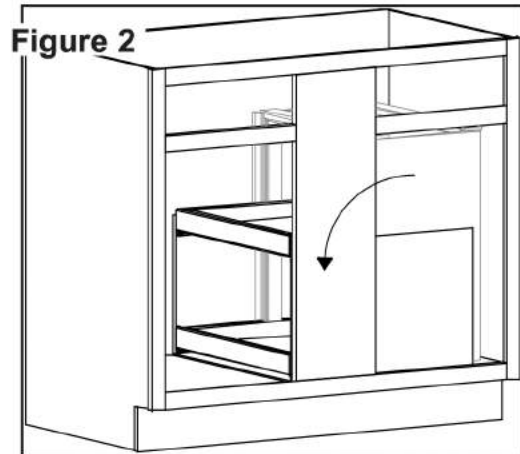

**Step 3:** Position unit so the drawer fronts are even with, or slightly behind, door opening. (See Figure 3)

Screw unit to cabinet bottom using the (4) # 8 x 3/4" screws (See figure 3A)

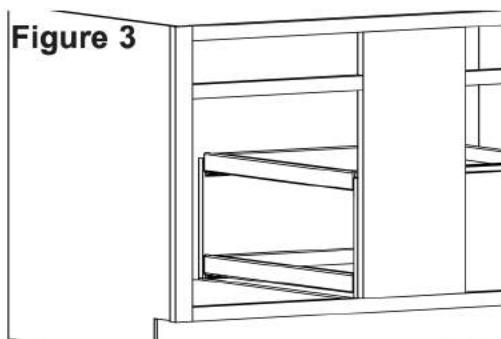
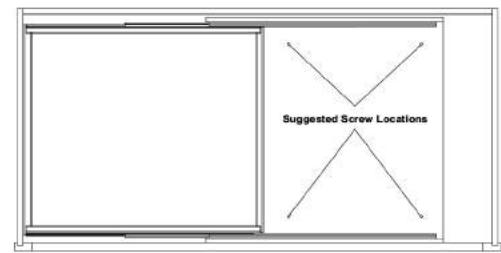
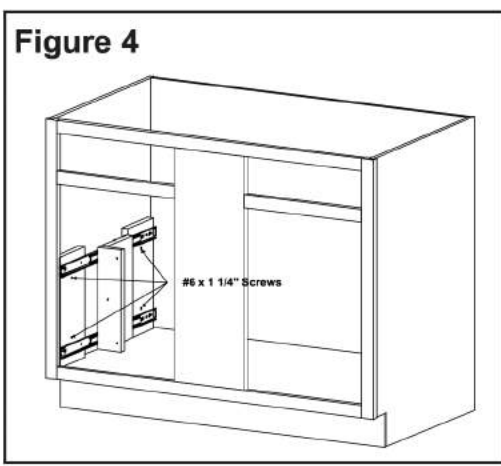

Figure 3A



**Step 4:** Position caddy slide assembly into cabinet, setting mounting rails on cabinet bottom and front of assembly against back of face frame.

Fasten slide assembly to cabinet side panel using (4) #6 x 1 1/4" screws. (See figure 4)



**Step 5:** Using supplied drilling template mark and then drill (3) 3/32" pilot holes in back of caddy on side unit is to hinge on. (See figure 5)

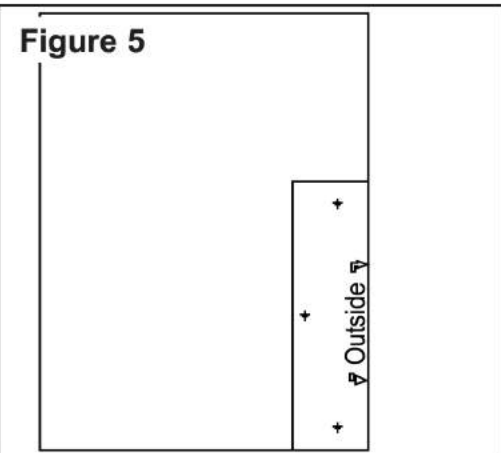

**Step 6:** Pull follower unit out and fasten caddy to follower using (3) #6 x 1 1/4" screws. (See figure 6).

